

FH

BAH

TA-CP

TA

MOX

HT

VH

TSI/TSX

T

MT-TC-TC3

Accessori
AccessoriesAppendice tecnica
Technical supplement

4-78



testa ad angolo - angle head

TAV10.P

caratteristiche/features



peso/weight



rotazione/rotation



prestazioni/performance

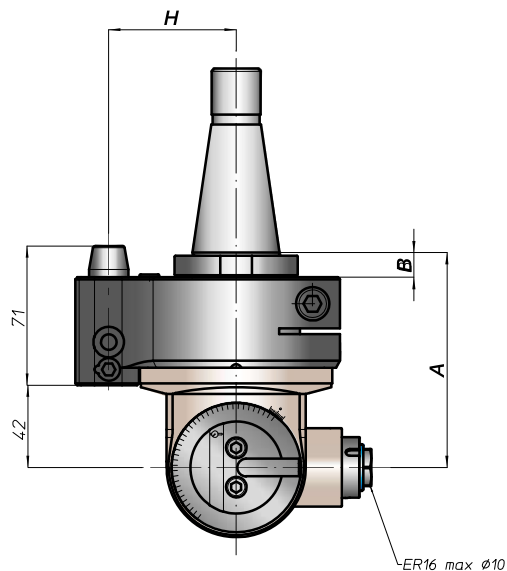
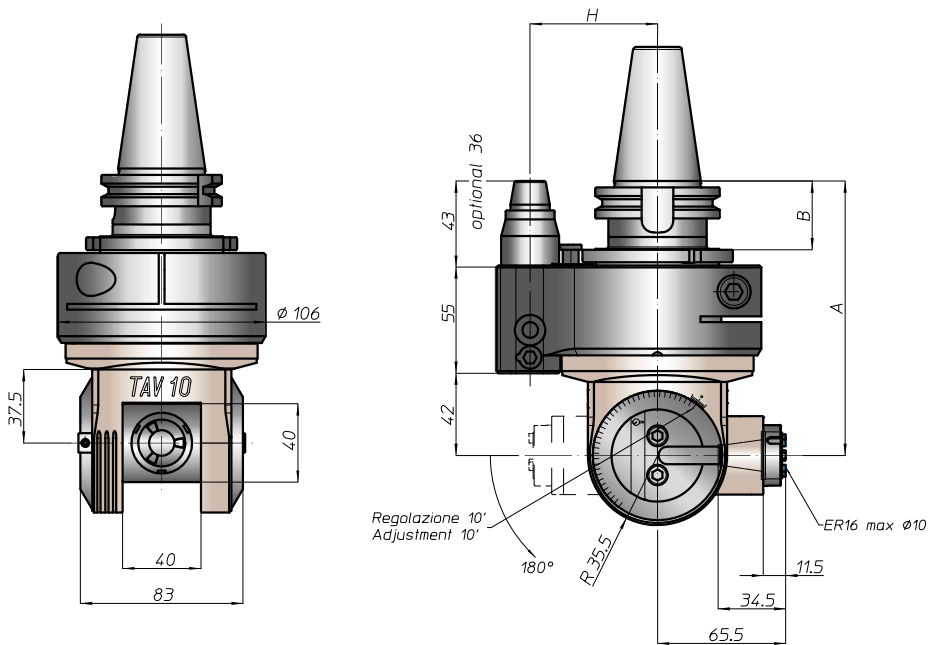
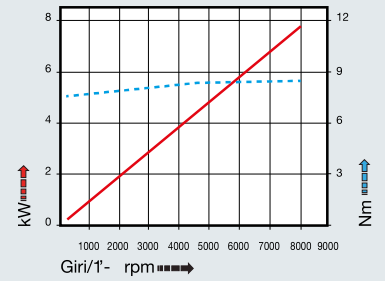

CONO SHANK	size	H		standard	optional
		A	B		
DIN69871 *	40	140	35	65	-
	45			80	110
	50			80	110
ANSIB5.50 *	40	148	45	65	-
	50			80	110
* BT	40	148	45	65	-
	50			80	110
HSK	63	149	46	65	-
	80			80	110
	100			80	110
DING6893	63	144	39	65	-
	80			80	110
	100			80	110
CAPTO	C5	144	39	65	-
	C6			80	110
	C8			80	110
ISO26623	63	140	46	65	-
	80			80	110
	100			80	110
KM	63	113	13	65	-
	80			80	110
	100			80	110
DIN2080	40	116	16	65	-
	50			80	110
	50			80	110
ANSIB5.18 NMTB	40	116	16	65	-
	50			80	110

* Option: Dual Contact



testa ad angolo - angle head

TAV13.P

caratteristiche/features



peso/weight



rotazione/rotation



prestazioni/performances

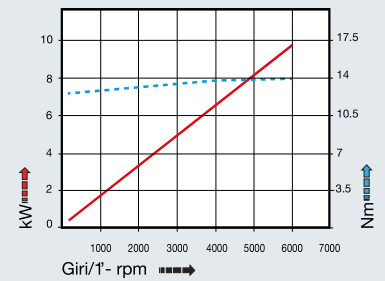

tipi mandrino disponibili / available spindle types

- 1** DIN6499-ER ER25
3 Weldon Whistle-Notch Ø16

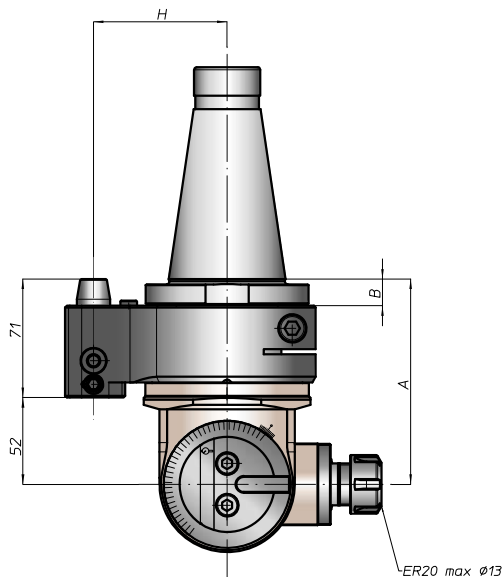
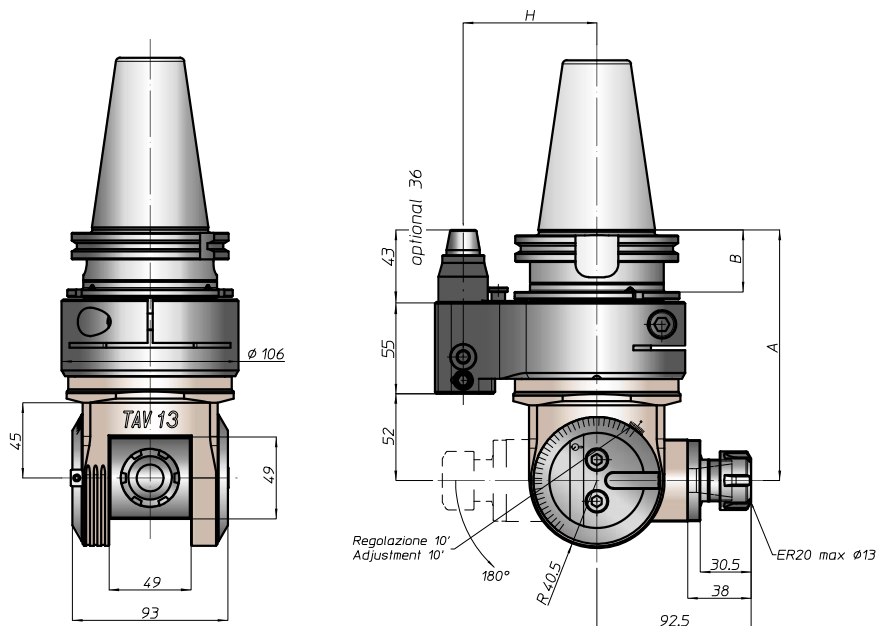

CONO SHANK	size	A	B	H	
				standard	optional
DIN69871 *	-	150	35	65	-
	40			80	110
	45				
* CAT ANSIB5.50	40	158	45	65	-
	50			80	110
* BT	40	158	45	65	-
	50			80	110
DIN69893 HSK	63	159	46	65	-
	80			80	110
	100				
ISO26623 CAPTO	C5	154	39	65	-
	C6			80	110
	C8				
KM	63	150	46	65	-
	80			80	110
	100				
DIN2080	-	120	13	65	-
	40			80	110
	50				
ANSIB5.18 NMTB	40	123	16	65	-
	50			80	110

* Option: Dual Contact

TAV30.P



caratteristiche/features

 $\varnothing 30$
 M24
  2740 N
 1-1
  2500

peso/weight



42 kg

rotazione/rotation



input



output

prestazioni/performance

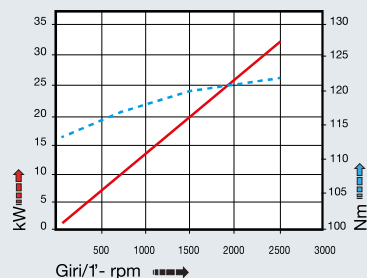

tipi mandrino disponibili / available spindle types

- 1** DIN6499-ER
ER50
- 2** Albero portafresa
Milling shaft
Ø32-Ø40
- 4** DIN69893-HSK
HSK63
- 6** ABS
Licenza KOMET®
ABS63

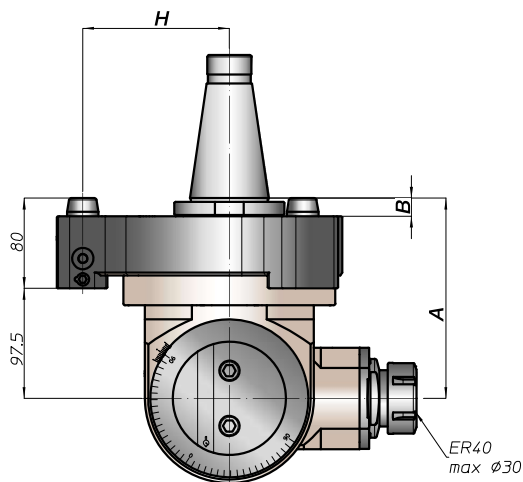
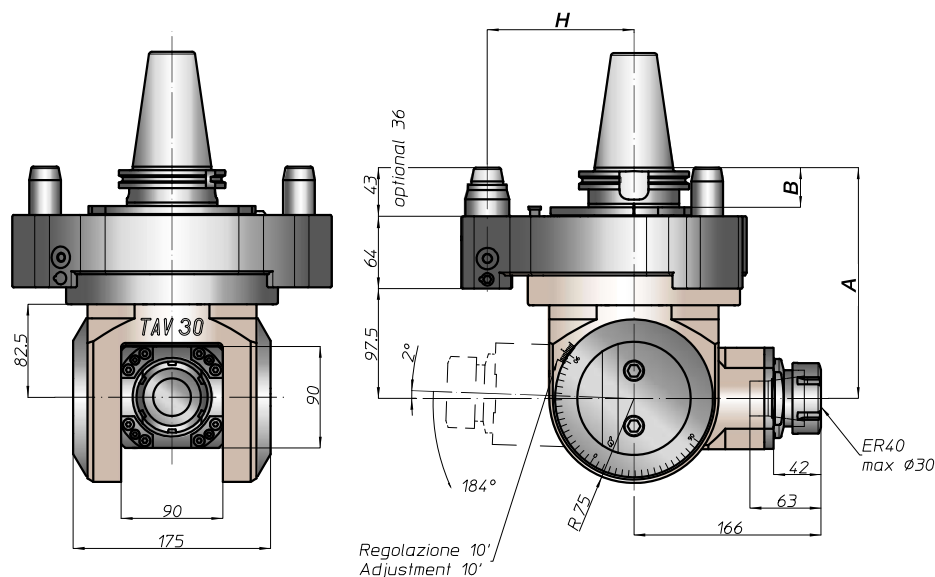

CONO SHANK	size	A	B	H	
				standard	optional
DIN69871 *	-	204,5	35	-	-
	50			130	-
ANSI B5.50 *	-	213,5	42	-	-
	50			130	-
BT *	-	213,5	46	-	-
	50			130	-
HSK	-	213,5	42	-	-
	100			130	-
ISO 6623	-	208,5	-	-	-
	C8			130	-
KM	-	204,5	-	-	-
	100			130	-
DIN2080	-	177,5	16	-	-
	50			130	-
ANSI B5.18 NMTB	-	177,5	16	-	-
	50			130	-

* Option: Dual Contact



TAV40.T



caratteristiche/features



peso/weight



70 kg

rotazione/rotation



prestazioni/performance

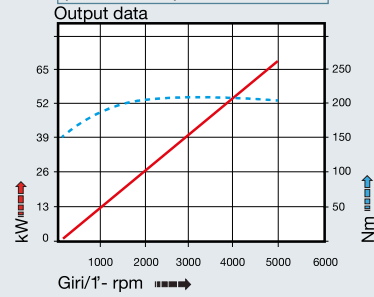

tipi mandrino disponibili / available spindle types

- 4** DIN69893-HSK
HSK63
- 5** COROMANT CAPTO®
C5

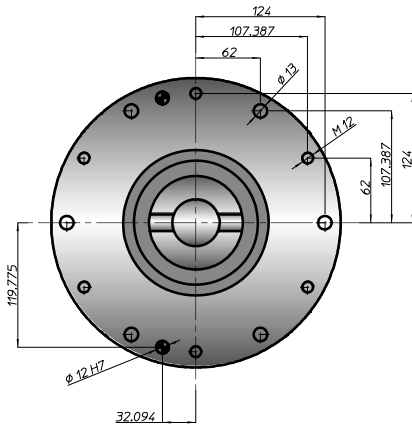
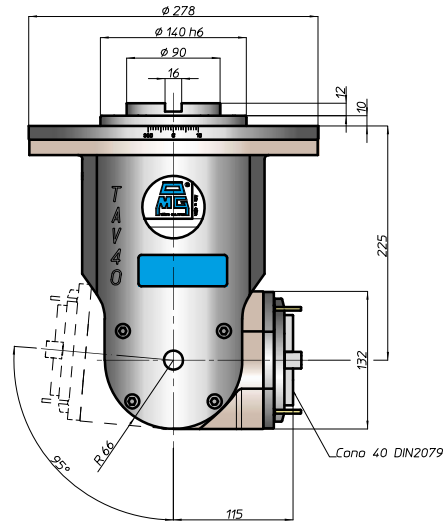
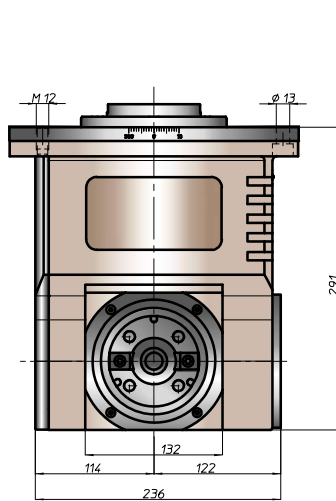

Equipaggiamento standard:

- pressurizzazione mandrino
- n. 4 ugelli orientabili vicino al mandrino
- regolazione angolare mandrino libera
- nel mandrino DIN2079 si possono utilizzare coni DIN2080-40, DIN69871-A40, MAS403-BT40

Standard equipment:

- spindle front pressurization
- nr 4 adjustable nozzle near the spindle
- free angle spindle adjustment
- on the spindle DIN2079 you can use shank DIN2080-40, DIN69871-A40, MAS403-BT40

esempio di collegamento - connection example

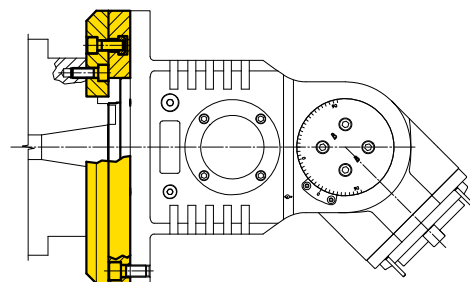

FH

BAH

TA-CP

TA

MOX

HT

VH

TSI/TSX

T

MT-TC-TC3

Accessori
Accessories

Appendice tecnica
Technical supplement

TAV50.T



caratteristiche/features



peso/weight



145 kg

rotazione/rotation



prestazioni/performances

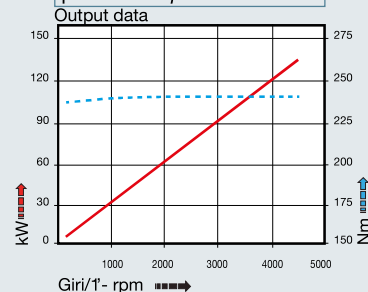

tipi mandrino disponibili / available spindle types

- 4** DIN69893-HSK **A100**
- 5** COROMANT CAPTO® **C8**

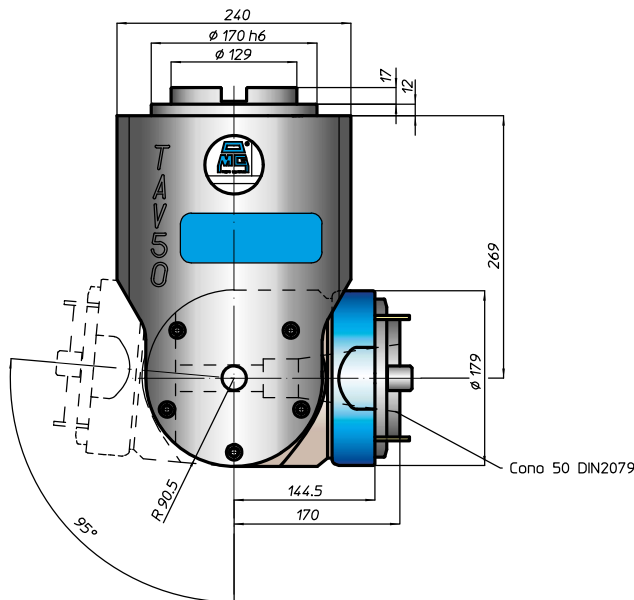
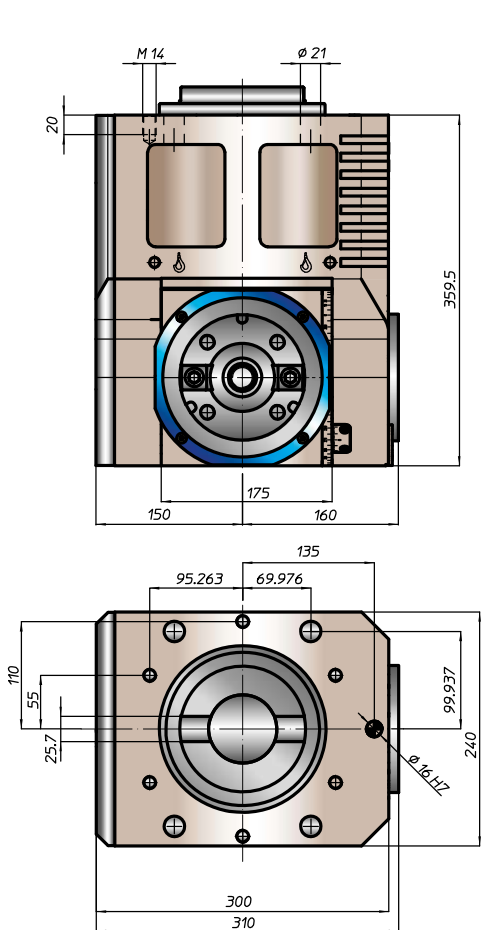

Equipaggiamento standard:

- pressurizzazione mandrino
- n. 4 ugelli orientabili vicino al mandrino
- regolazione angolare mandrino libera o posizionabile ogni 15°
- nel mandrino DIN2079 si possono utilizzare coni DIN69871-A50, MAS403-BT50

Standard equipment:

- spindle front pressurization
- nr 4 adjustable nozzle near the spindle
- free angle spindle adjustment or by pin each 15°
- on the spindle DIN2079 you can use shank DIN69871-A50, MAS403-BT50

esempio di collegamento - connection example

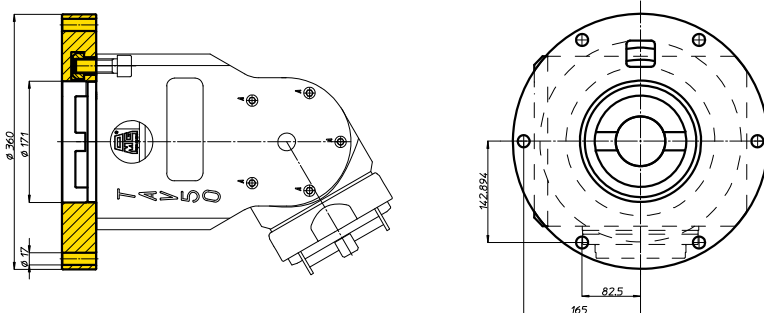

FH
BAH
TA-CP
TA

MOx

HT

VH

TSI/TSX

T

MT-TC-TC3

Accessori
Accessories

Appendice tecnica
Technical supplement



TAV Gallery



FH

BAH

TA-CP

TA

MOx

HT

VH

TSI/TSX

T

MT-TC-TC3

Accessori
Accessories

Appendice tecnica
Technical supplement

