

TA07.P



caratteristiche/features



peso/weight



rotazione/rotation



prestazioni/performance

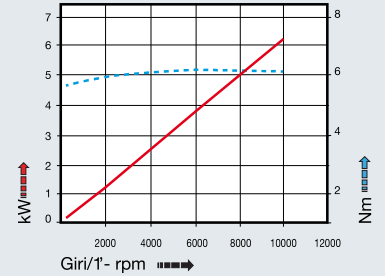

tipi mandrino disponibili / available spindle types

3 Weldon
 Whistle-Notch
 $\varnothing 8$ - $\varnothing 10$

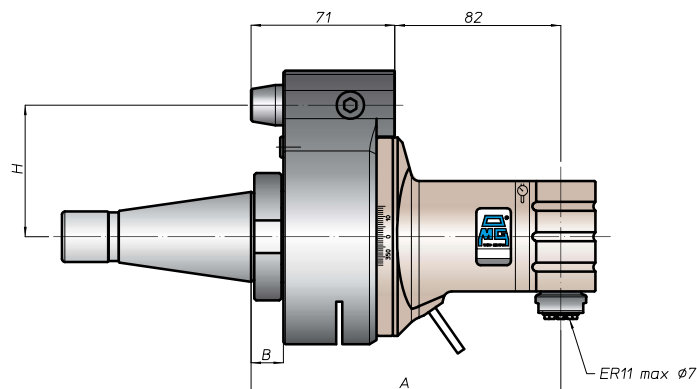
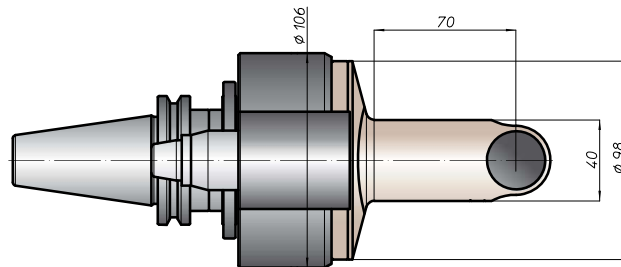
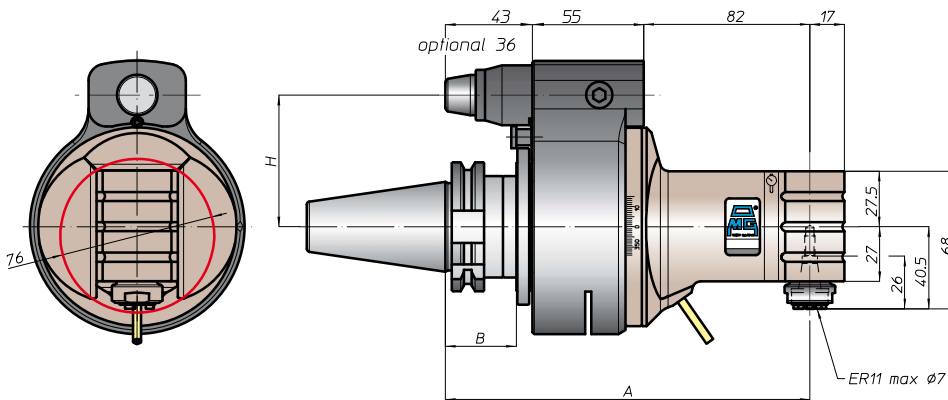

CONO SHANK	size	H			
		A	B	standard	optional
DIN69871 *	30	180	35	65	-
	40			80	110
	45			80	110
	50			80	110
ANSIB5.50 *	40	188	45	65	-
	50			80	110
* BT	40	188	45	65	-
	50			80	110
DIN69893	HSK 63	189	46	65	-
	80			80	110
	100			80	110
ISO26623	C5	184	39	65	-
	C6			80	110
	C8			80	110
KM	63	180	-	65	-
	80			80	110
	100			80	110
DIN2080	-	150	13	65	-
	40			80	110
	-			153	16
ANSIB5.18 NMTB	40	153	16	65	-
	50			80	110

* Option: Dual Contact

TA10.P



caratteristiche/features

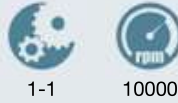

peso/weight

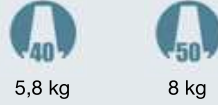

rotazione/rotation



prestazioni/performance

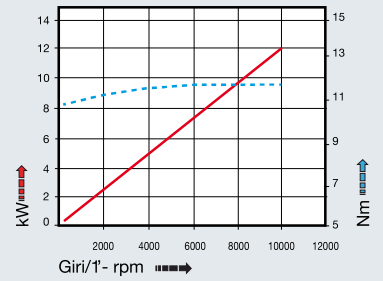

tipi mandrino disponibili / available spindle types

- 1** DIN6499-ER **2** Albero portafresa Milling shaft **3** Weldon Whistle-Notch
- ER20** **Ø16** **Ø8-10-12**

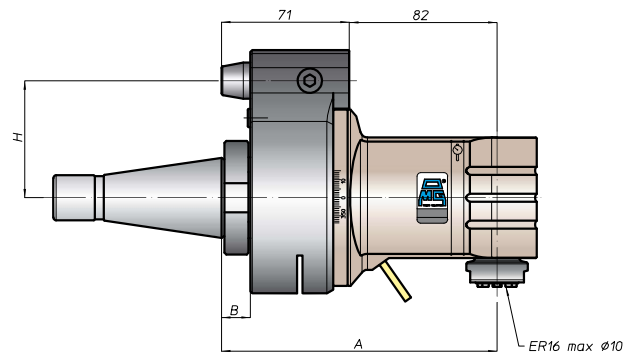
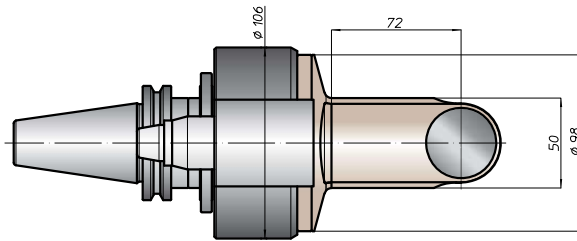
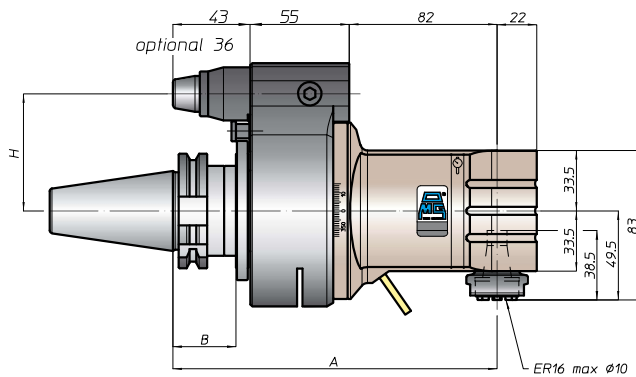
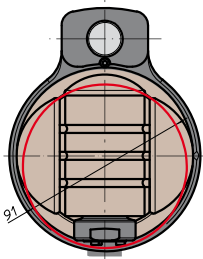

CONO SHANK	size	H			
		A	B	standard	optional
DIN69871 *	30	180	35	65	-
	40			80	110
	45			80	110
	50			80	110
ANSIB5.50 *	40	188	45	65	-
	50			80	110
* BT	40	188	45	65	-
	50			80	110
HSK	63	189	46	65	-
	80			80	110
	100			80	110
DIN69893	63	180	39	65	-
	80			80	110
	100			80	110
CAPTO	C5	184	39	65	-
	C6			80	110
	C8			80	110
ISO26623	63	150	13	65	-
	80			80	110
	100			80	110
KM	63	153	16	65	-
	80			80	110
	100			80	110
DIN2080	-	150	13	65	-
	40			80	110
	-			80	110
ANSIB5.18 NMTB	40	153	16	65	-
	50			80	110

* Option: Dual Contact

TA13.P



caratteristiche/features



peso/weight

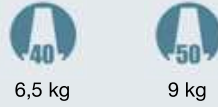

rotazione/rotation



prestazioni/performance

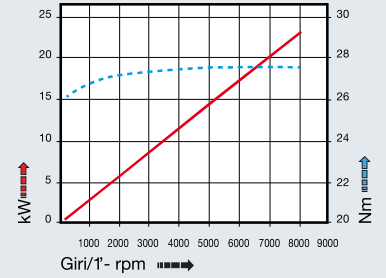

tipi mandrino disponibili / available spindle types

1 DIN6499-ER	2 Albero portafrese Milling shaft	3 Weldon Whistle-Notch	6 ABS Licenza KOMET®
ER25	Ø16-Ø22	Ø16	ABS25

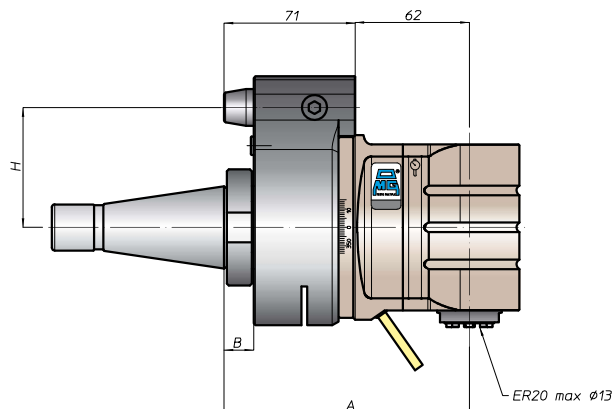
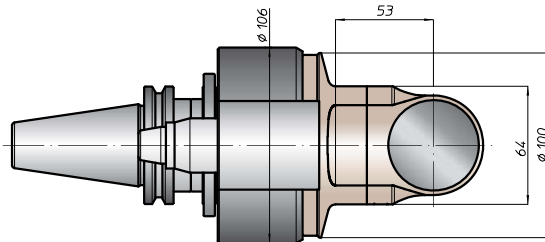
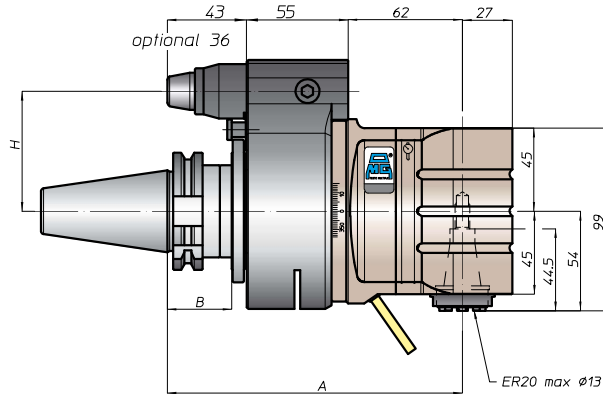
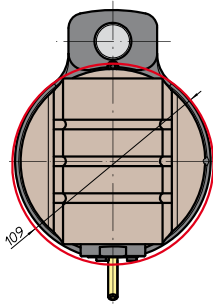

CONO SHANK	size	H			
		A	B	standard	optional
DIN69871 *	-	160	35	65	-
	40			80	110
	45			80	110
ANSIB5.50 *	40	168	45	65	-
	50			80	110
* BT	40	168	45	65	-
	50			80	110
DIN69893	HSK 63	169	46	65	-
	80			80	110
	100			80	110
ISO26623	C5	164	39	65	-
	C6			80	110
	C8			80	110
KM	63	160	-	65	-
	80			80	110
	100			80	110
DIN2080	-	130	13	65	-
	40			80	110
	50			80	110
ANSIB5.18 NMTB	40	133	16	65	-
	50			80	110

* Option: Dual Contact

testa ad angolo - angle head

TA16.P



caratteristiche/features



peso/weight

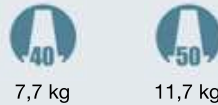

rotazione/rotation



prestazioni/performance

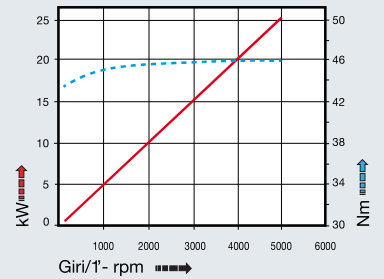

tipi mandrino disponibili / available spindle types

- 1 DIN6499-ER
ER32
- 2 Albero portafresa
Milling shaft
Ø16-Ø22-Ø27-Ø32
- 3 Weldon
Whistle-Notch
Ø20
- 4 DIN69893-HSK
HSK32
- 5 COROMANT
CAPTO®
C3
- 6 ABS
Licenza KOMET®
ABS32

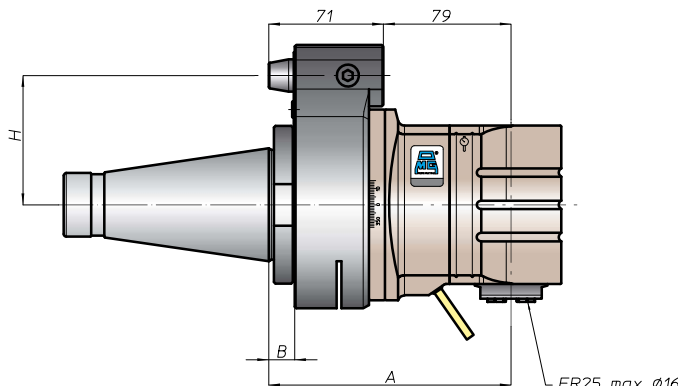
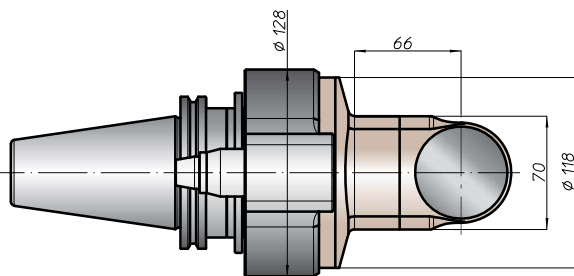
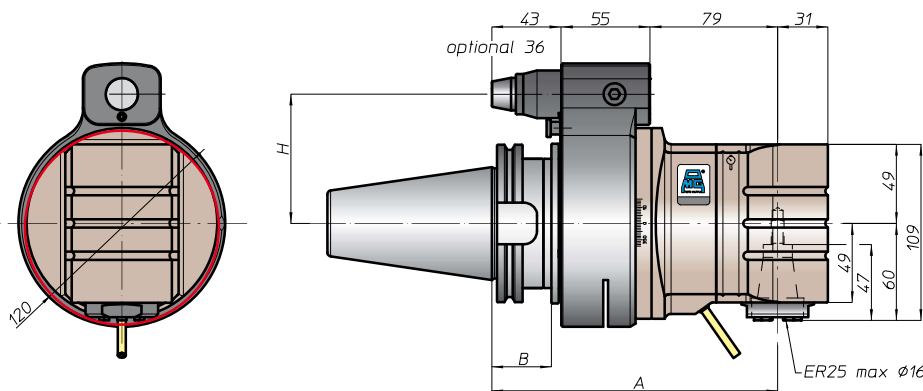

CONO SHANK	size	A	B	H	
				standard	optional
DIN69871 *	-	172	35	65	-
	40	172	35	65	-
	45	177	35	80	110
	50	177	35	80	110
ANSIB5.50 *	40	172	35	65	-
	50	177	35	80	110
* BT	40	172	35	65	-
	50	185	45	80	110
DIN69893	HSK	63	181	44	65
	80	186	46	80	110
	100	186	46	80	110
ISO26623	C5	176	39	65	-
	C6	181	39	80	110
	C8	181	39	80	110
KM	63	172	35	65	-
	80	177	35	80	110
	100	177	35	80	110
DIN2080	-	147	13	65	-
	40	150	16	80	110
	50	150	16	80	110
ANSIB5.18 NMTB	40	142	13	65	-
	50	150	16	80	110

* Option: Dual Contact



FH

BAH

TA-CP

TA

MOX

HT

VH

TSI/TSX

T

MT-TC-TC3

Accessori
Accessories

Appendice tecnica
Technical supplement

testa ad angolo - angle head

TA20.P



caratteristiche/features



peso/weight



rotazione/rotation



prestazioni/performance

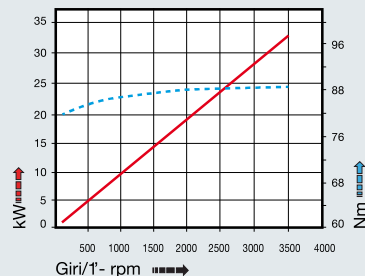

tipi mandrino disponibili / available spindle types

- 1** DIN6499-ER
ER40
- 2** Albero portafresa
Milling shaft
Ø22-Ø27-Ø32
- 3** Weldon
Whistle-Notch
Ø20-Ø25-Ø32
- 4** DIN69893-HSK
HSK40
- 5** COROMANT
CAPTO®
C4
- 6** ABS
Licenza KOMET®
ABS40

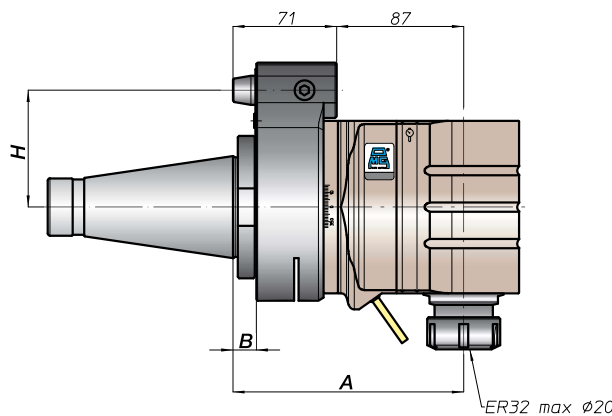
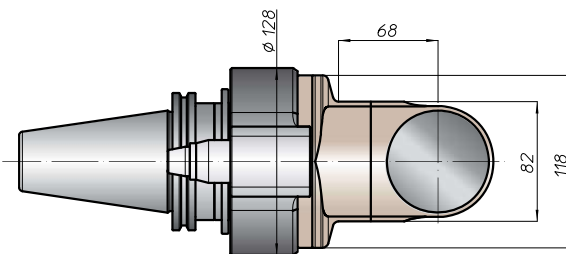
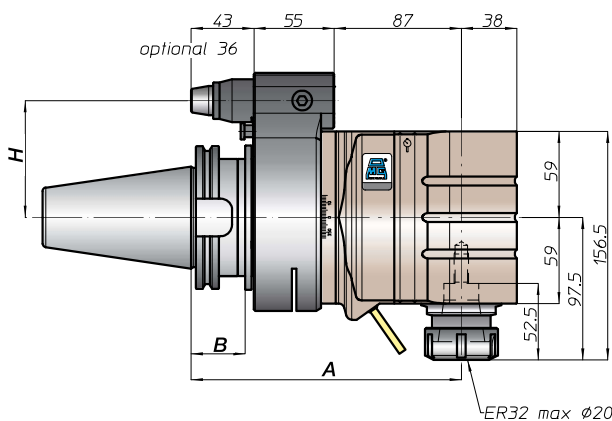
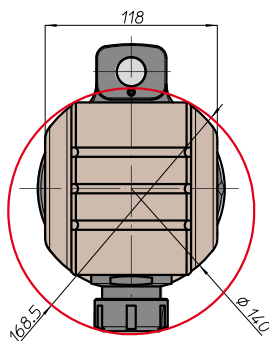

CONO SHANK	size	H			
		A	B	standard	optional
DIN69871 *	-	-	-	-	-
	45	185	35	80	110
	50			80	110
ANSIB5.50 *	-	-	-	-	-
	50	-	-	80	110
* BT	-	-	-	-	-
	50	193	45	80	110
HSK	-	-	-	-	-
DIN69893	80	194	46	80	110
	100			80	110
CAPTO	-	-	-	-	-
ISO26623	-	189	-	80	110
	C8			80	110
KM	-	-	-	-	-
	80	185	-	80	110
	100			80	110
DIN2080	-	-	-	-	-
	-	158	16	80	110
	50			80	110
ANSIB5.18 NMTB	-	-	-	-	-
	50	158	16	80	110

* Option: Dual Contact

TA

TA-CP

BAH

FH

MOX

HT

VH

TSI/TSX

T

MT-TC-TC3

Accessori
Accessories

Appendice tecnica
Technical supplement



TA20.30



caratteristiche/features



peso/weight



14,7 kg

rotazione/rotation



input



output

prestazioni/performance

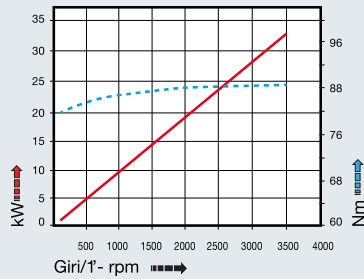

CONO SHANK	size	A	B	H	
				standard	optional
* DIN69871	-	185	35	-	-
	45			80	110
ANSIB5.50	-	185	35	-	-
	50			80	110
* BT	-	193	45	-	-
	50			80	110
DIN69893	HSK	194	46	-	-
	80			80	110
ISO26623	-	189	-	-	-
	C8			80	110
KM	-	185	-	-	-
	80			80	110
DIN2080	-	158	16	-	-
	50			80	110
ANSIB5.18	-	158	16	-	-
	50			80	110

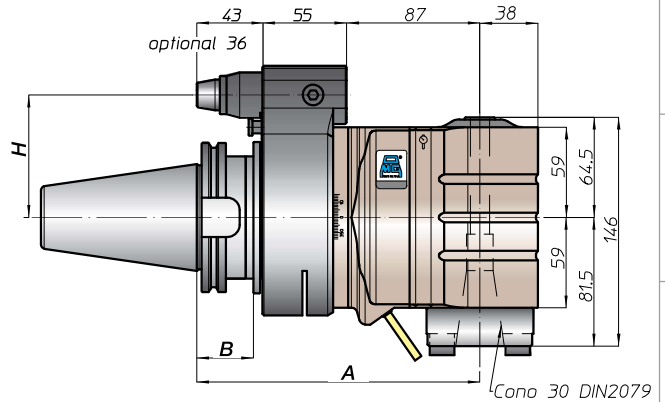
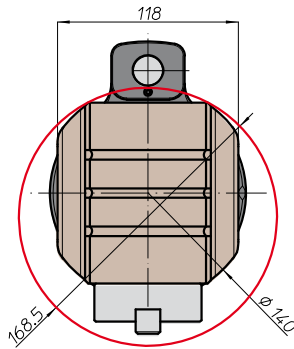

Nota:

- nel mandrino DIN2079 si possono utilizzare coni DIN2080-30, DIN69871-A30, MAS403-BT30

Note:

- on the spindle DIN2079 you can use shank DIN2080-30, DIN69871-A30, MAS403-BT30

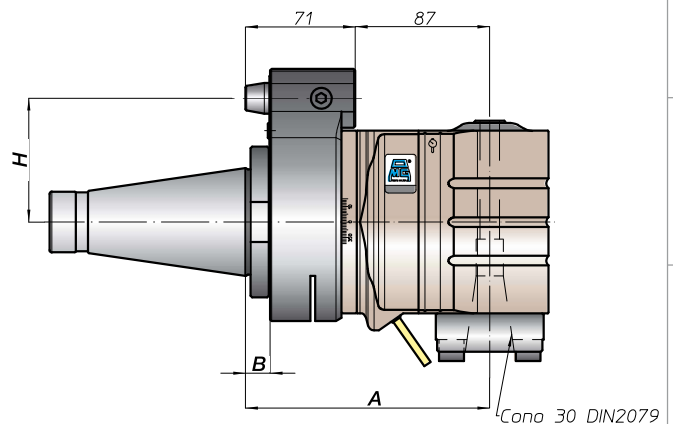
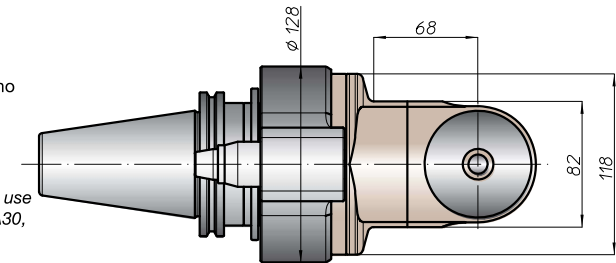

* Option: Dual Contact

TA26.P



caratteristiche/features



peso/weight



22 kg

rotazione/rotation



prestazioni/performance

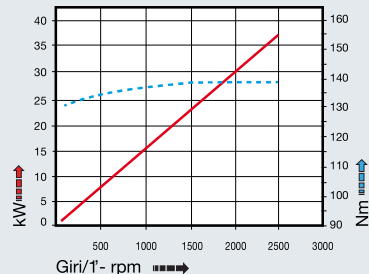

tipi mandrino disponibili / available spindle types

- 1** DIN6499-ER
ER50
- 2** Albero portafresa
Milling shaft
Ø16-Ø27-Ø32-Ø40
- 3** Weldon
Whistle-Notch
Ø32
- 4** DIN69893-HSK
HSK63
- 5** COROMANT
CAPTO®
C4-C5-C6
- 6** ABS
Licenza KOMET®
ABS50

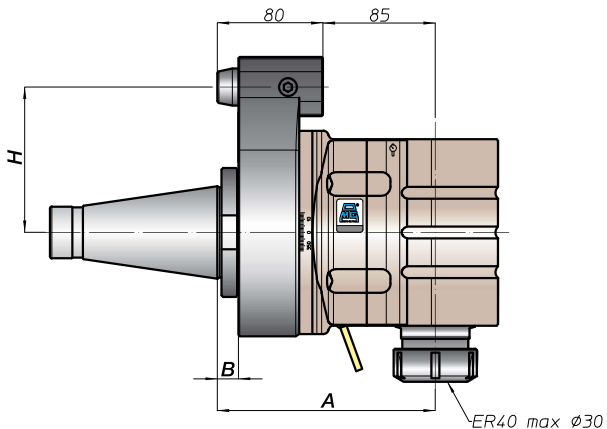
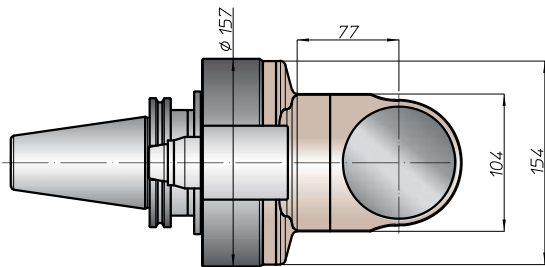
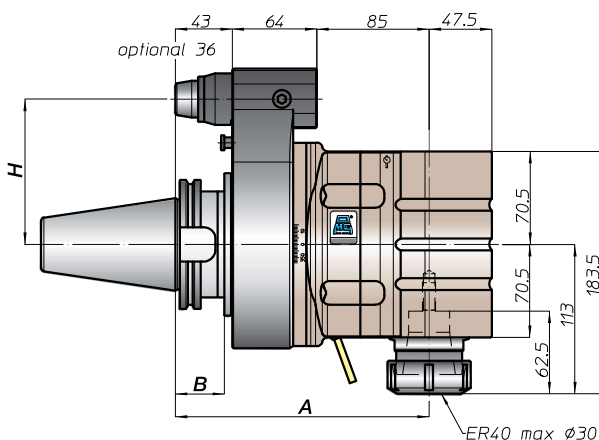
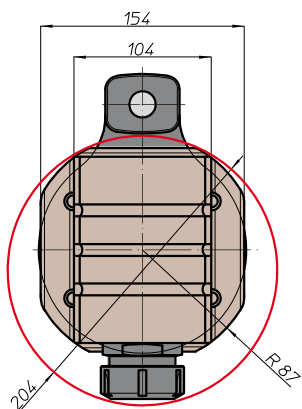

CONO SHANK	size	H			
		A	B	standard	optional
DIN69871 *	-	-	-	-	-
DIN69871 *	45	192	35	-	-
DIN69871 *	50			110	-
ANSIB5.50 *	-	-	-	-	-
ANSIB5.50 *	50	-	-	110	-
BT *	-	-	-	-	-
BT *	50	200	45	110	-
HSK	-	-	-	-	-
DIN69893	80	201	46	110	-
DIN69893	100				
CAPTO	-	196	-	-	-
ISO26623	-				
C8	-	-	-	-	-
KM	-	192	-	-	-
KM	100				
DIN2080	-	-	-	-	-
DIN2080	-	165	16	110	-
DIN2080	50				
NMTB	-	-	-	-	-
ANSIB5.18	50	165	16	110	-

* Option: Dual Contact

FH

BAH

TA-CP

TA

MOX

HT

VH

TSI/TSX

T

MT-TC-TC3

Accessori
Accessories

Appendice tecnica
Technical supplement



TA26.40



caratteristiche/features



peso/weight



22 kg

rotazione/rotation



input



output

prestazioni/performance

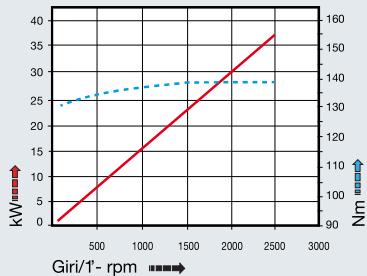

CONO SHANK	size	A	B	H	
				standard	optional
* DIN69871	-	192	35	-	-
	45			110	-
ANSIB5.50	-	192	35	-	-
	50			110	-
* BT	-	200	45	110	-
	50			201	46
DIN69893	80	201	46	110	-
	100			110	-
CAPTO	-	196	-	-	-
	C8			110	-
KM	-	192	-	-	-
	100			110	-
DIN2080	-	165	16	110	-
	50			110	-
ANSIB5.18 NMTB	-	165	16	-	-
	50			110	-

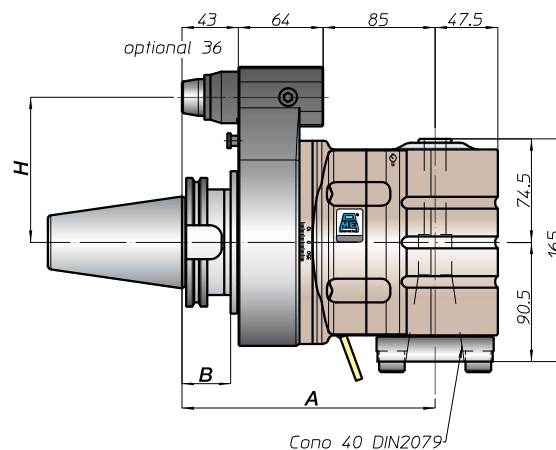
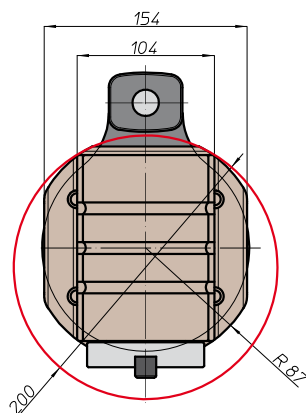

Nota:

- nel mandrino DIN2079 si possono utilizzare coni DIN2080-40, DIN69871-A40, MAS403-BT40

Note:

- on the spindle DIN2079 you can use shank DIN2080-40, DIN69871-A40, MAS403-BT40

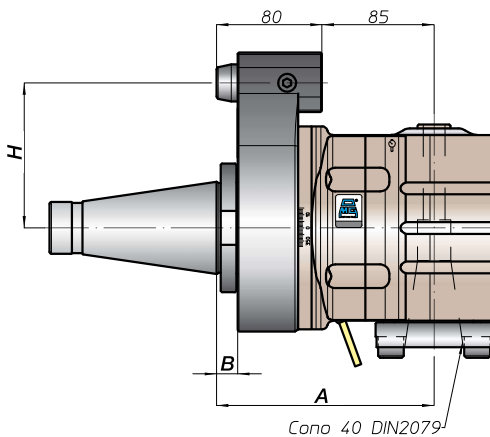
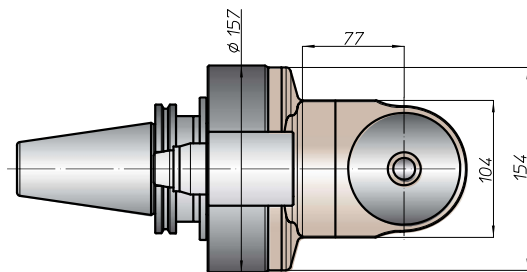

* Option: Dual Contact

TA30.P



caratteristiche/features



peso/weight



24 kg

rotazione/rotation



prestazioni/performance

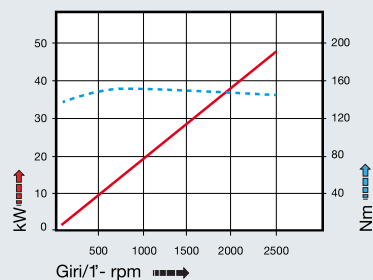

tipi mandrino disponibili / available spindle types

- 2** Albero portafrese / Milling shaft **Ø40**
- 4** DIN69893-HSK **HSK63**

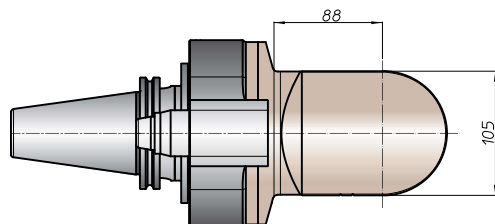
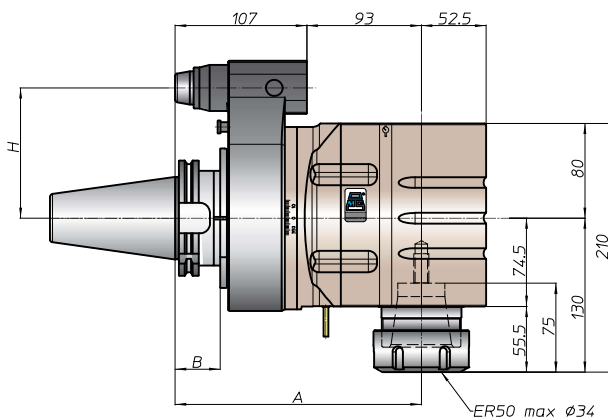
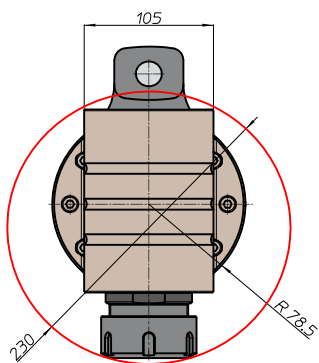

CONO SHANK	size	H			
		A	B	standard	optional
DIN69871 *	-	-	-	-	-
ANSIB5.50 *	50	200	36,5	110	-
BT *	50	208	45	110	-
HSK	-	-	-	-	-
DIN69893	100	209	46	110	-
ISO26623	C8	204	-	110	-
KM	-	-	-	-	-
DIN2080	-	-	-	-	-
ANSIB5.18 NMTB	-	-	-	-	-

* Option: Dual Contact

FH

BAH

TA-CP

TA

MOX

HT

VH

TSI/TSX

T

MT-TC-TC3

Accessori
Accessories

Appendice tecnica
Technical supplement



TA30.40



caratteristiche/features



peso/weight



22 kg

rotazione/rotation



input output

prestazioni/performance

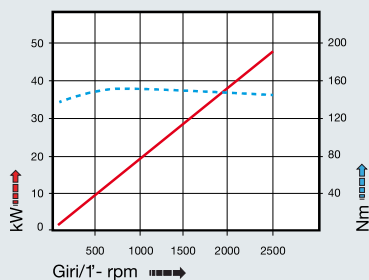

CONO SHANK	size	A	B	H	
				standard	optional
* DIN69871	-	192	35	-	-
	45			110	-
* ANSIB5.50 CAT	-	192	35	-	-
	50			110	-
* BT	-	200	45	110	-
	50			110	-
HSK	-	201	46	110	-
	80			110	-
DIN69893	-	201	46	110	-
	100			110	-
CAPTO	-	196	-	110	-
	-			110	-
ISO26623	-	196	-	110	-
	C8			110	-
KM	-	192	-	110	-
	-			110	-
DIN2080	-	165	16	110	-
	-			110	-
ANSIB5.18 NMTB	-	165	16	110	-
	50			110	-

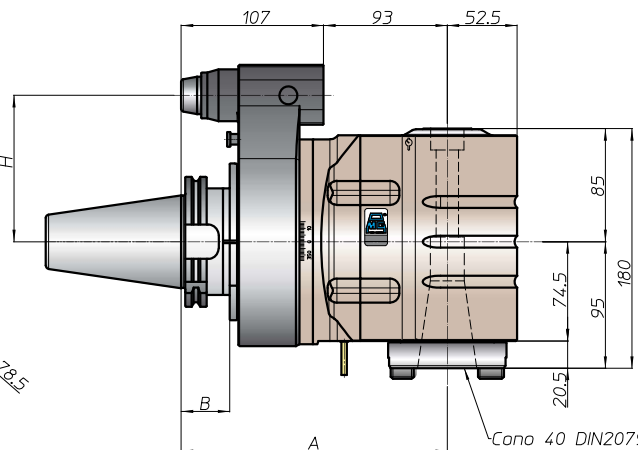
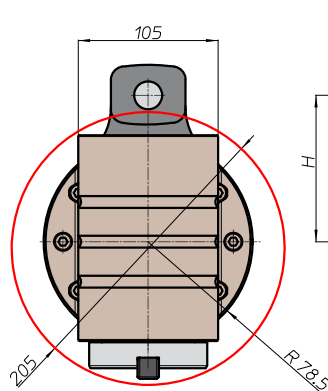

Nota:

- nel mandrino DIN2079 si possono utilizzare coni DIN2080-40, DIN69871-A40, MAS403-BT40

Note:

- on the spindle DIN2079 you can use shank DIN2080-40, DIN69871-A40, MAS403-BT40

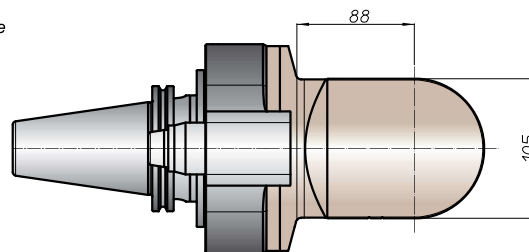

* Option: Dual Contact

