

TA07P.T



caratteristiche/features



peso/weight



rotazione/rotation



prestazioni/performance

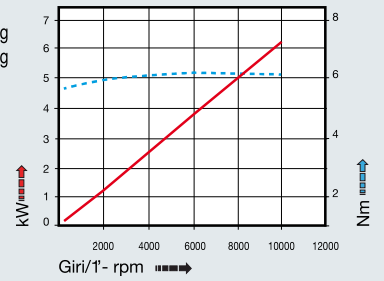

tipi mandrino disponibili / available spindle types

3 Weldon Whistle-Notch
Ø8-Ø10

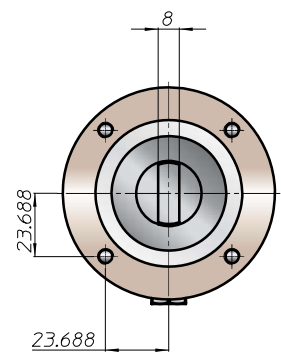
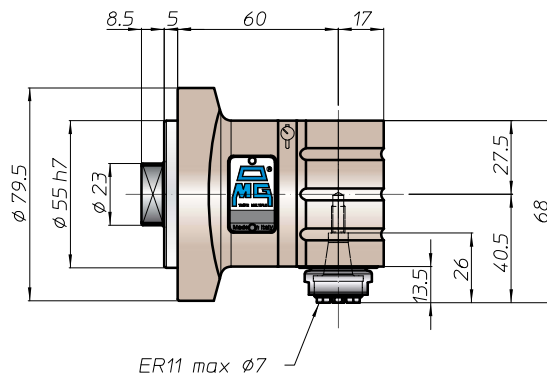
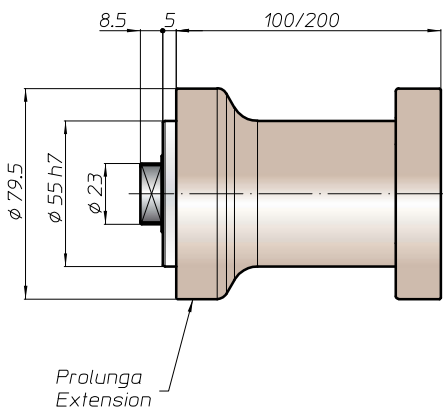
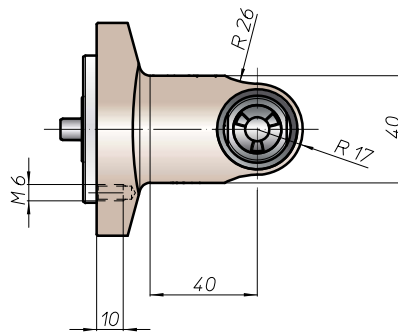

esempio di collegamento - connection example

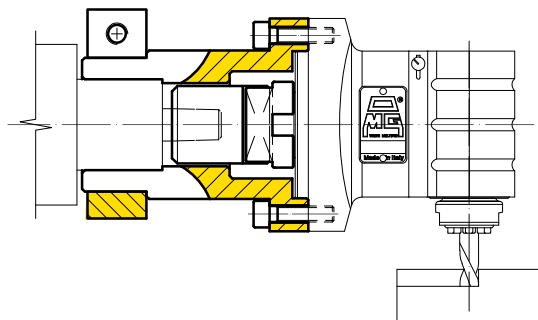

FH

BAH

TA-CP

TA

MOx

HT

VH

TSI/TSX

T

MT-TC-TC3

Accessori
Accessories

Appendice tecnica
Technical supplement



TA10P.T



caratteristiche/features



peso/weight

head 2,7 kg
 extension L 100=2,2 kg
 L 200=3,6 kg

rotazione/rotation



prestazioni/performances

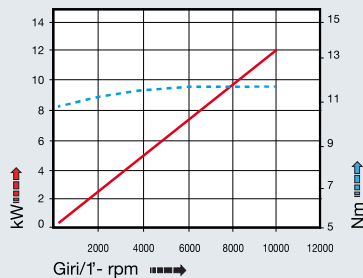

tipi mandrino disponibili / available spindle types

- 1** DIN6499-ER **ER20**
- 2** Albero portafresa Milling Shaft **Ø16**
- 3** Weldon Whistle-Notch **Ø10**

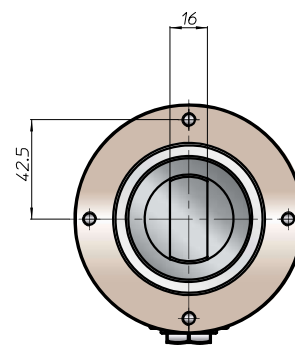
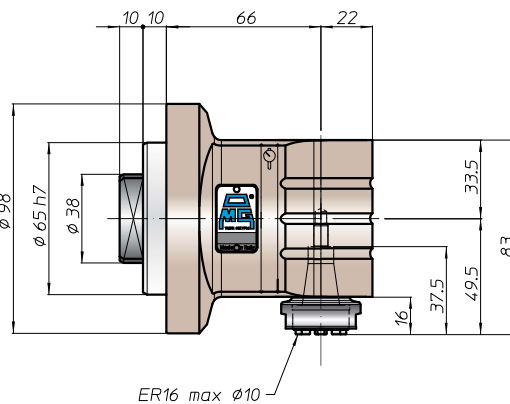
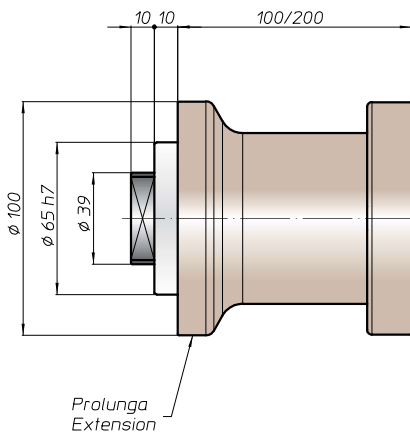
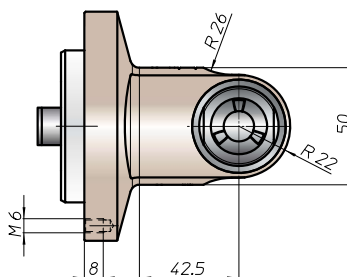

esempio di collegamento - connection example

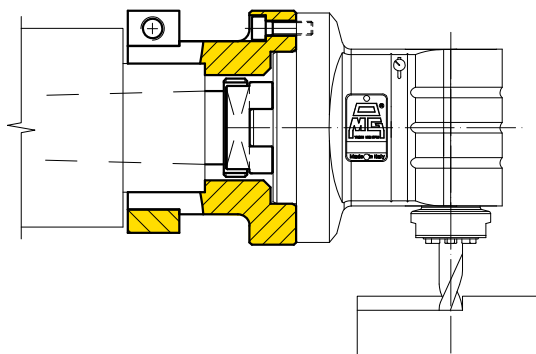

TA13P.T



caratteristiche/features



peso/weight



rotazione/rotation



prestazioni/performance

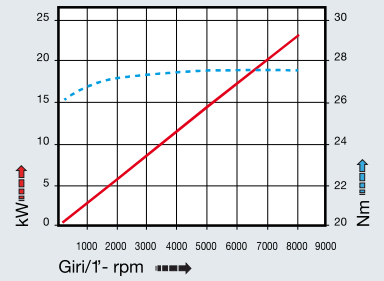

tipi mandrino disponibili / available spindle types

- 1** DIN6499-ER **ER25**
- 2** Albero portafrese Milling shaft **Ø16-Ø22**
- 3** Weldon Whistle-Notch **Ø16**

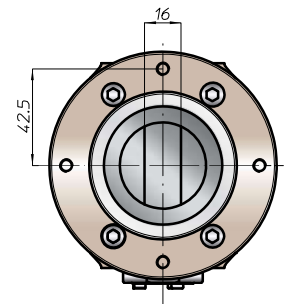
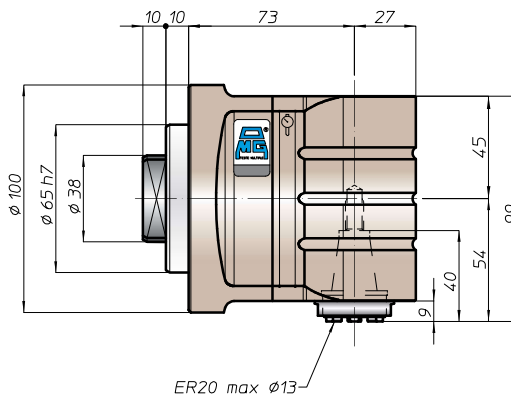
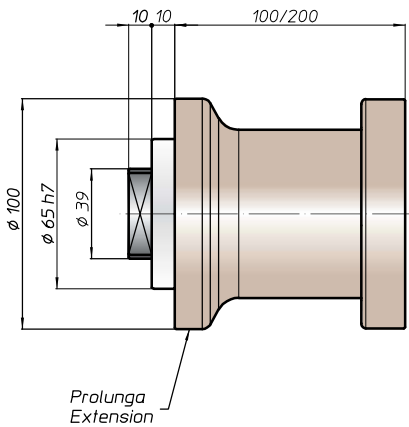
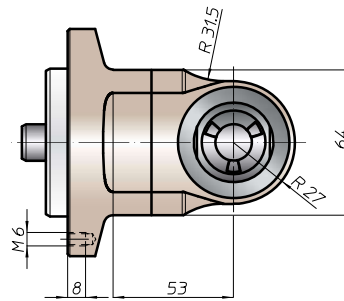

esempio di collegamento - *connection example*

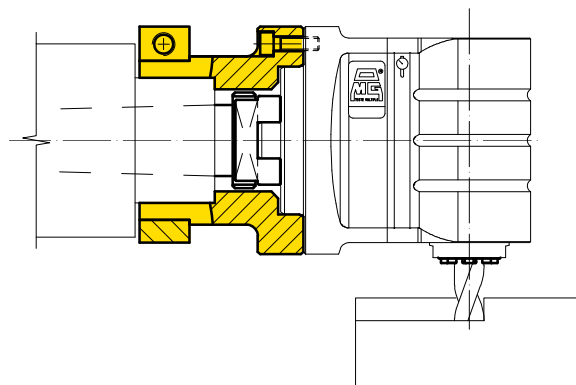

FH

BAH

TA-CP

TA

MOx

HT

VH

TSI/TSX

T

MT-TC-TC3

Accessori
Accessories

Appendice tecnica
Technical supplement



TA16P.T



caratteristiche/features



peso/weight



rotazione/rotation



prestazioni/performance

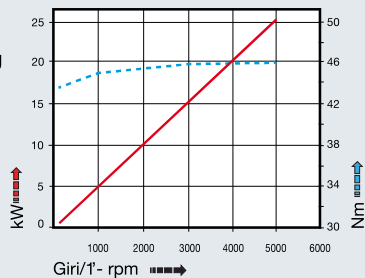

tipi mandrino disponibili / available spindle types

- | | | | | | |
|---------------------|--|-------------------------------|-----------------------|--------------------------|-----------------------------|
| 1 DIN6499-ER | 2 Albero portafrese Milling shaft | 3 Weldon Whistle-Notch | 4 DIN69893-HSK | 5 COROMANT CAPTO® | 6 ABS Licenza KOMET® |
| ER32 | Ø16-Ø22-Ø27-Ø32 | Ø20 | HSK32 | C3 | ABS32 |

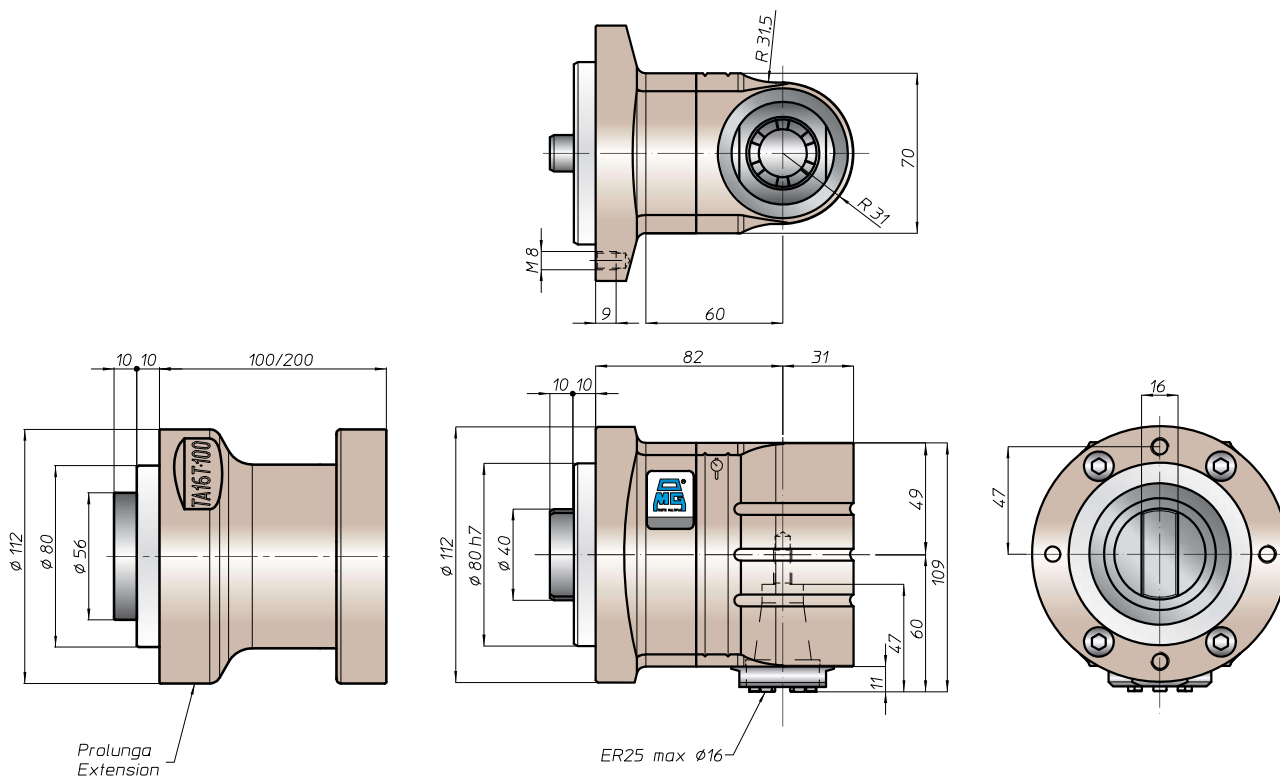

esempio di collegamento - connection example

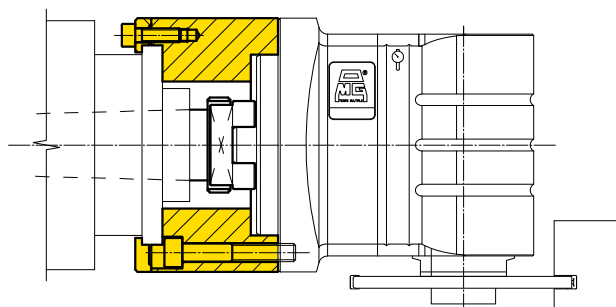

FH

BAH

TA-CP

TA

MOX

HT

VH

TSI/TSX

T

MT-TC-TC3

Accessori
Accessories

Appendice tecnica
Technical supplement



TA20.PT



caratteristiche/features



peso/weight



rotazione/rotation



prestazioni/performance

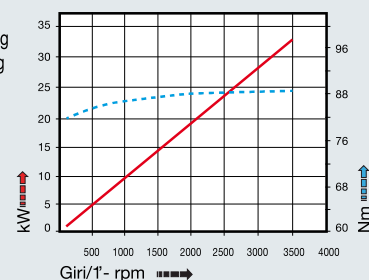

tipi mandrino disponibili / available spindle types

- | | | | | | |
|------------------------------------|---|--|---------------------------------------|--|--|
| 1 DIN6499-ER
ER40 | 2 Albero portafresa
Milling shaft
Ø22-Ø27-Ø32 | 3 Weldon
Whistle-Notch
Ø20-Ø25 | 4 DIN69893-HSK
HSK40 | 5 COROMANT
CAPTO®
C4 | 6 ABS
Licenza KOMET®
ABS40 |
|------------------------------------|---|--|---------------------------------------|--|--|

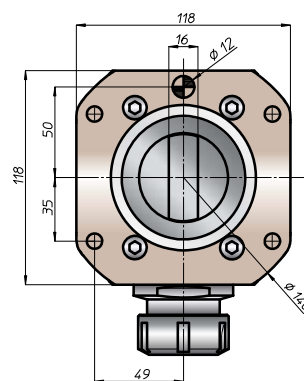
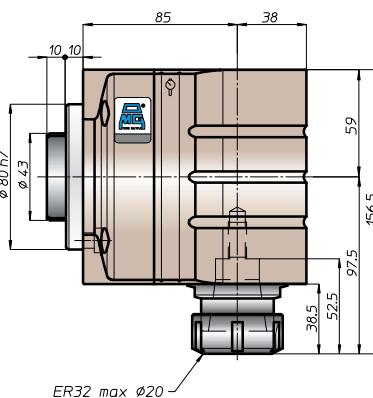
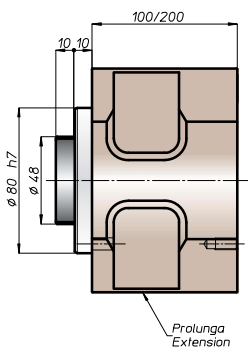
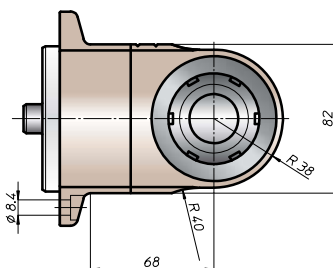

esempio di collegamento - *connection example*

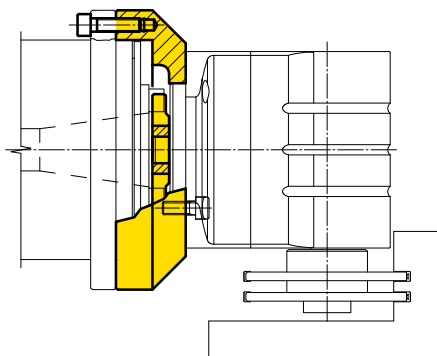

FH

BAH

TA-CP

TA

MOx

HT

VH

TSI/TSX

T

MT-TC-TC3

Accessori
Accessories

Appendice tecnica
Technical supplement



TA20.30.T



caratteristiche/features



peso/weight



rotazione/rotation



prestazioni/performance

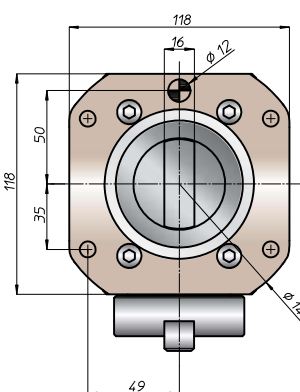
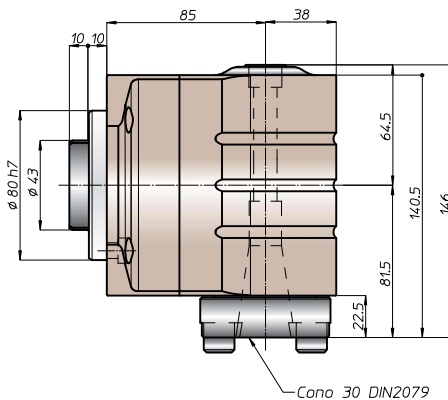
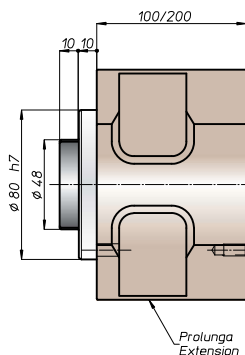
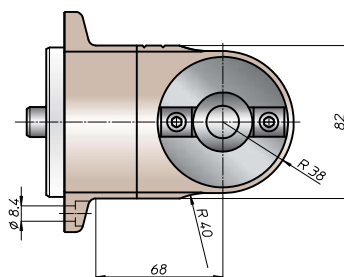
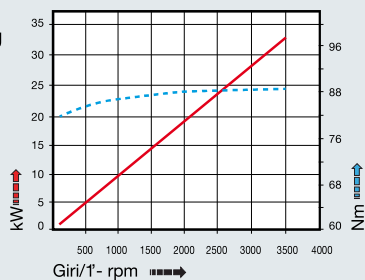

Nota:

- nel mandrino DIN2079 si possono utilizzare coni DIN2080-30, DIN69871-A30, MAS403-BT30

Note:

- on the spindle DIN2079 you can use shank DIN2080-30, DIN69871-A30, MAS403-BT30

esempio di collegamento - connection example

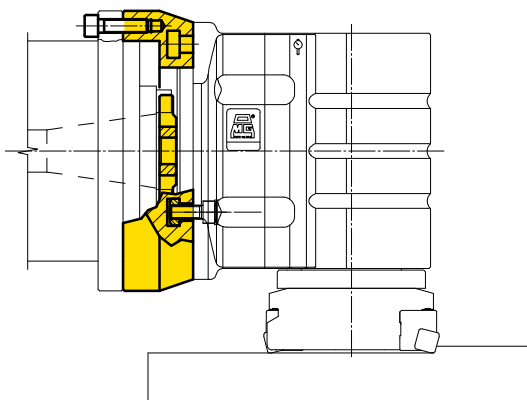

FH

BAH

TA-CP

TA

MOX

HT

VH

TSI/TSX

T

MT-TC-TC3

Accessori
Accessories

Appendice tecnica
Technical supplement

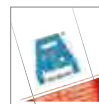

TA26.PT



caratteristiche/features



peso/weight



rotazione/rotation



prestazioni/performance

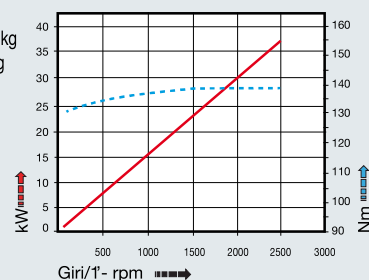

tipi mandrino disponibili / available spindle types

- | | | | | |
|---|----------------------------------|-----------------------|-----------------------------|--------------------------------|
| 2 Albero portafrese
Milling shaft | 3 Weldon
Whistle-Notch | 4 DIN69893-HSK | 5 COROMANT
CAPTO® | 6 ABS
Licenza KOMET® |
| Ø16-Ø27-Ø32 | Ø32 | HSK63 | C4 | ABS50 |

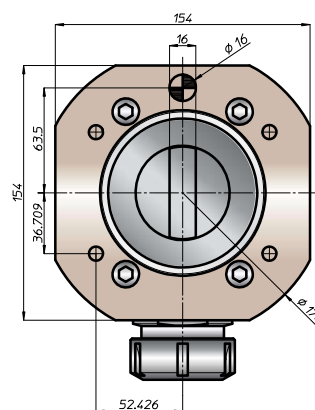
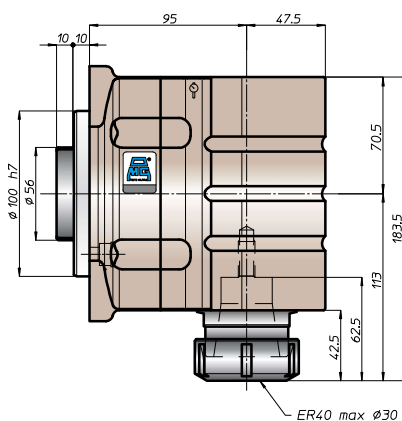
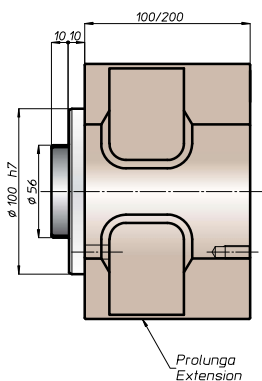
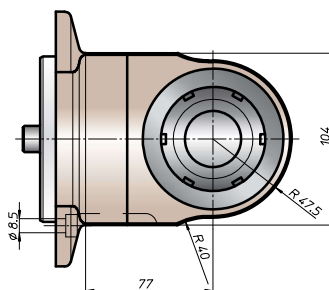

esempio di collegamento - *connection example*



FH

BAH

TA-CP

TA

MOx

HT

VH

TSI/TSX

T

MT-TC-TC3

Accessori
Accessories

Appendice tecnica
Technical supplement



TA26.40.T



caratteristiche/features



peso/weight



rotazione/rotation



prestazioni/performance

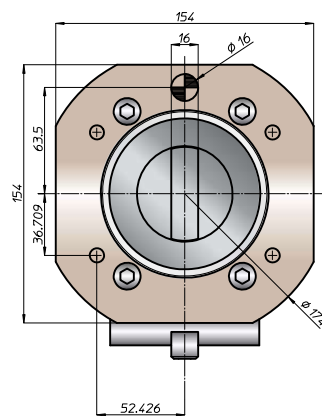
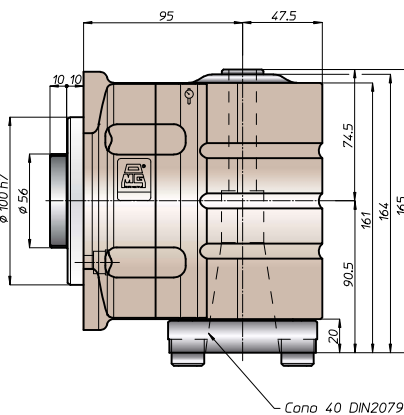
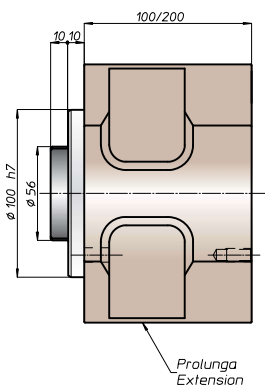
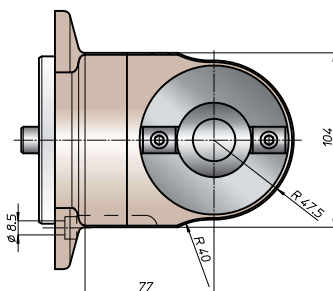
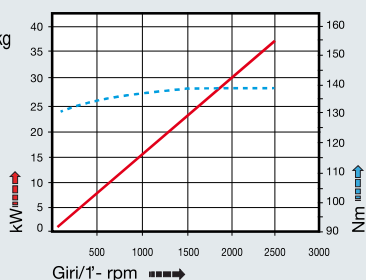

Nota:
 • nel mandrino DIN2079 si possono utilizzare coni
 DIN2080-40, DIN69871-A40, MAS403-BT40

Note:
 • on the spindle DIN2079 you can use shank
 DIN2080-40, DIN69871-A40, MAS403-BT40

esempio di collegamento - connection example



FH

BAH

TA-CP

TA

MOx

HT

VH

TSI/TSX

T

MT-TC-TC3

Accessori
Accessories

Appendice tecnica
Technical supplement



TA40.T



caratteristiche/features



peso/weight



rotazione/rotation



prestazioni/performance

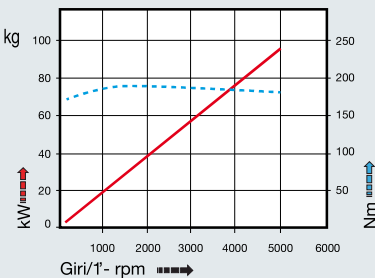

tipi mandrino disponibili / available spindle types

- 4** DIN69893-HSK **HSK63**
- 5** COROMANT CAPTO® **C5**

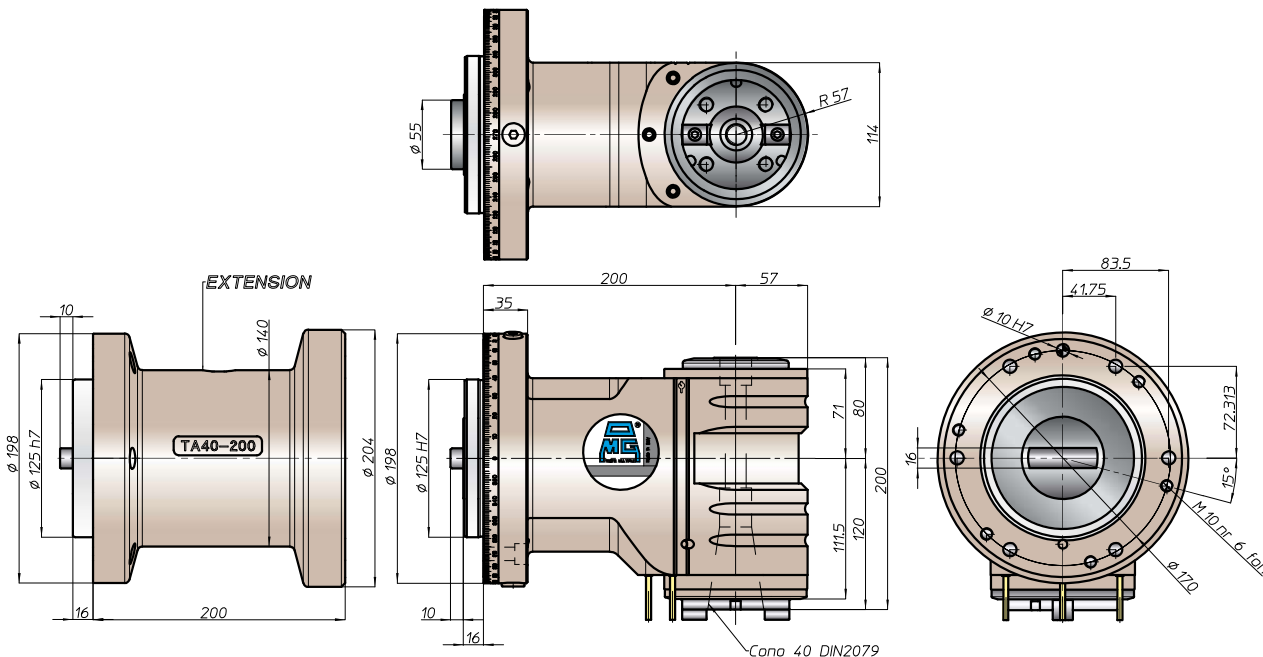

Equipaggiamento standard:

- pressurizzazione mandrino
- n. 3 ugelli orientabili vicino al mandrino
- nel mandrino DIN2079 si possono utilizzare coni DIN2080-40, DIN69871-A40, MAS403-BT40

Standard equipment:

- spindle front pressurization
- nr 3 adjustable nozzle near the spindle
- on the spindle DIN2079 you can use shank DIN2080-40, DIN69871-A40, MAS403-BT40

utilizzo su asse C-310 manuale - *example with manual C axis C-310*

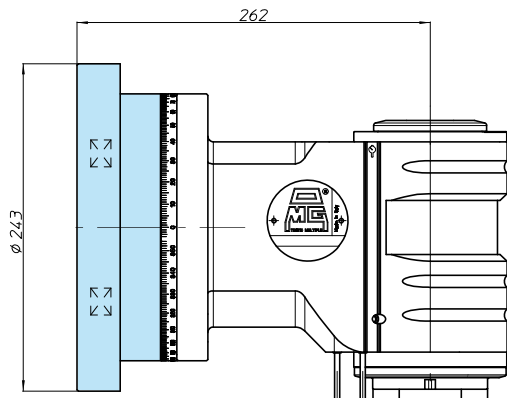

- Nuovo Asse C a rotazione manuale
- Compatto, semplice e preciso
- Bloccaggio rotazione su cava a T
- Rotazione libera su cuscinetto a rulli incrociati
- Facilità di posizionamento

- *New C Axis with manual rotation*
- *Space-saving, user friendly and precise*
- *Rotation lock on T slot*
- *Free rotation on crossed roller bearings*
- *Easy set up*

FH

BAH

TA-CP

TA

MOx

HT

VH

TSI/TSX

T

MT-TC-TC3

Accessori
Accessories

Appendice tecnica
Technical supplement



TA40.TD



caratteristiche/features



peso/weight



rotazione/rotation



prestazioni/performance

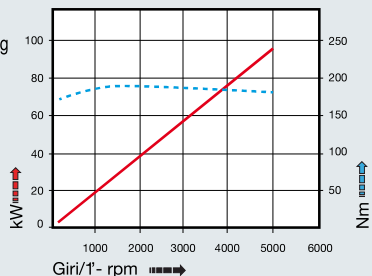

tipi mandrino disponibili / available spindle types

- 4** DIN69893-HSK **5** COROMANT CAPTO®
- HSK63** **C5**

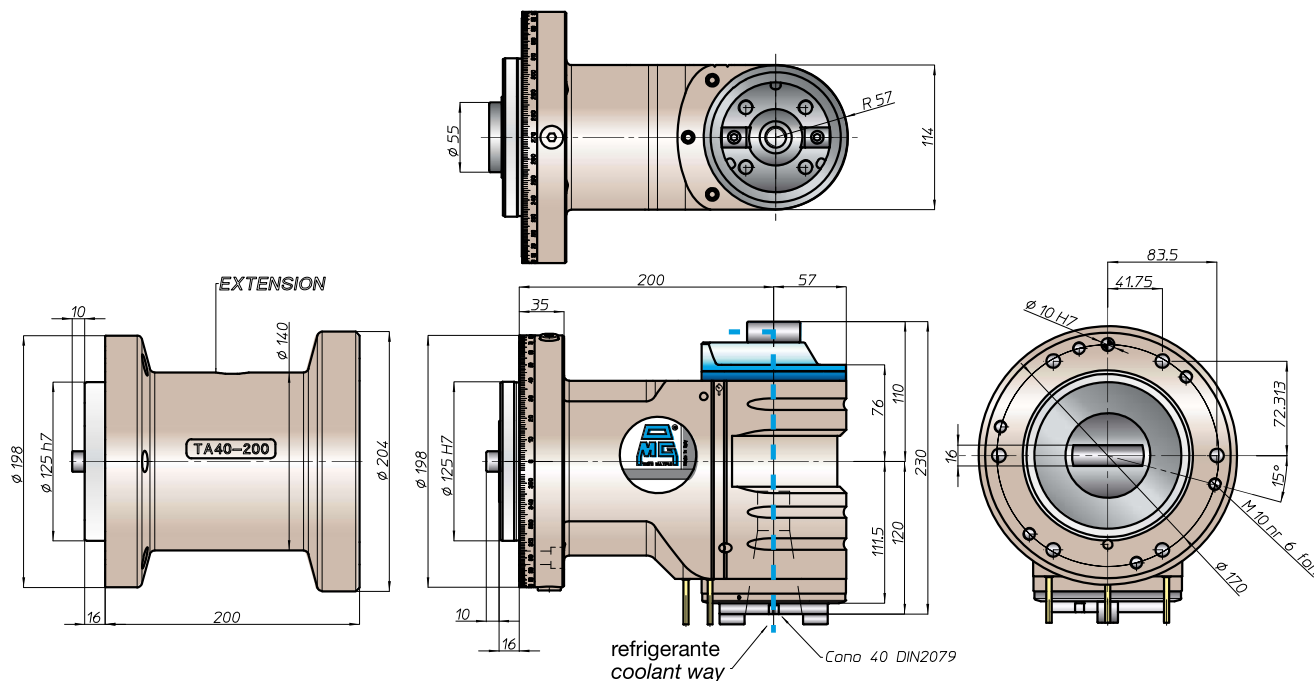

Equipaggiamento standard:

- pressurizzazione mandrino
- n. 3 ugelli orientabili vicino al mandrino
- nel mandrino DIN2079 si possono utilizzare coni DIN2080-40, DIN69871-A40, MAS403-BT40

Standard equipment:

- spindle front pressurization
- nr 3 adjustable nozzle near the spindle
- on the spindle DIN2079 you can use shank DIN2080-40, DIN69871-A40, MAS403-BT40

esempio di collegamento - connection example

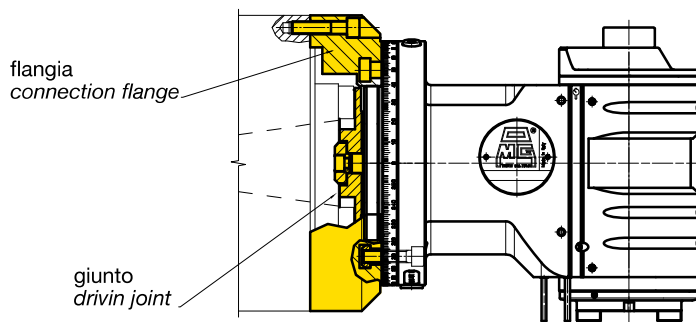

FH

BAH

TA-CP

TA

MOX

HT

VH

TSI/TSX

T

MT-TC-TC3

Accessori
Accessories

Appendice tecnica
Technical supplement



TA50.T



caratteristiche/features



peso/weight



rotazione/rotation



prestazioni/performance

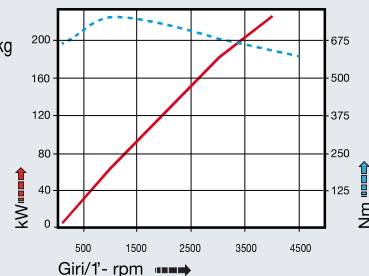

tipi mandrino disponibili / available spindle types

- 4** DIN69893-HSK
HSK100
- 5** COROMANT CAPTO®
C8

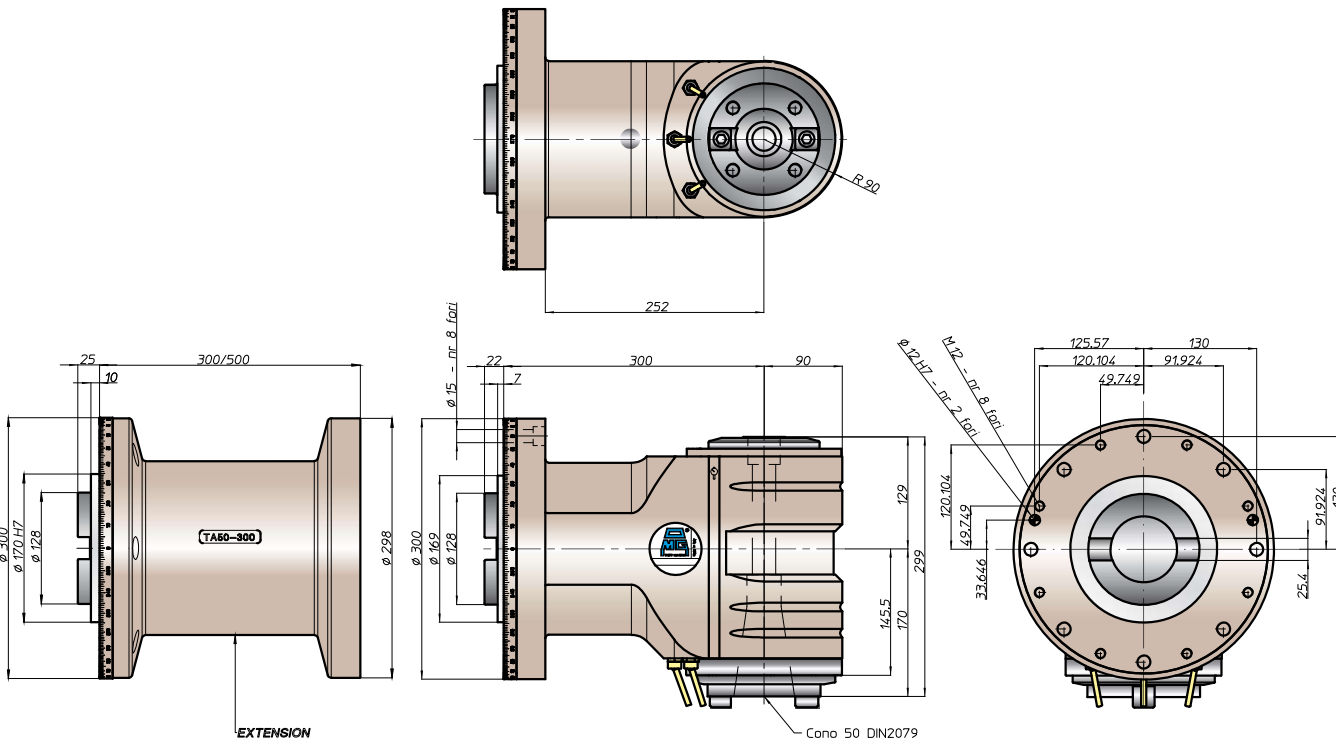

Equipaggiamento standard:

- pressurizzazione mandrino
- n. 3 ugelli orientabili vicino al mandrino
- nel mandrino DIN2079 si possono utilizzare coni DIN2080-50, DIN69871-A50, MAS403-BT50

Standard equipment:

- spindle front pressurization
- nr 3 adjustable nozzle near the spindle
- on the spindle DIN2079 you can use shank DIN2080-50, DIN69871-A50, MAS403-BT50

utilizzo su asse C-310 manuale - example with manual C axis C-310

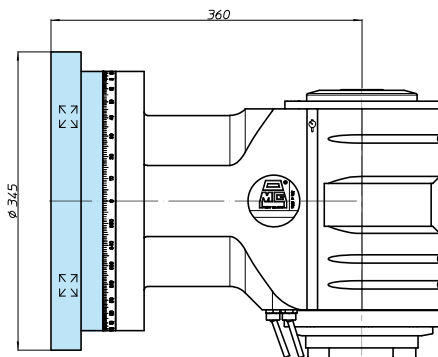

- Nuovo Asse C a rotazione manuale
- Compatto, semplice e preciso
- Bloccaggio rotazione su cava a T
- Rotazione libera su cuscinetto a rulli incrociati
- Facilità di posizionamento

- New C Axis with manual rotation
- Space-saving, user friendly and precise
- Rotation lock on T slot
- Free rotation on crossed roller bearings
- Easy set up

TA

TA-CP

BAH

FH

MOx

HT

VH

TSI/TSX

T

MT-TC-TC3

Accessori
Accessories

Appendice tecnica
Technical supplement



TA50.TD

caratteristiche/features



peso/weight



rotazione/rotation



prestazioni/performance

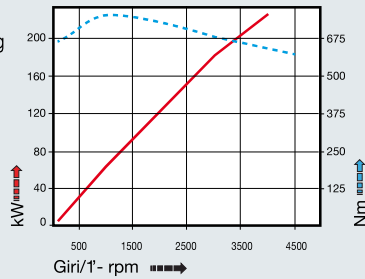

tipi mandrino disponibili / available spindle types

- 4** DIN69893-HSK **5** COROMANT CAPTO®
- HSK100** **C8**

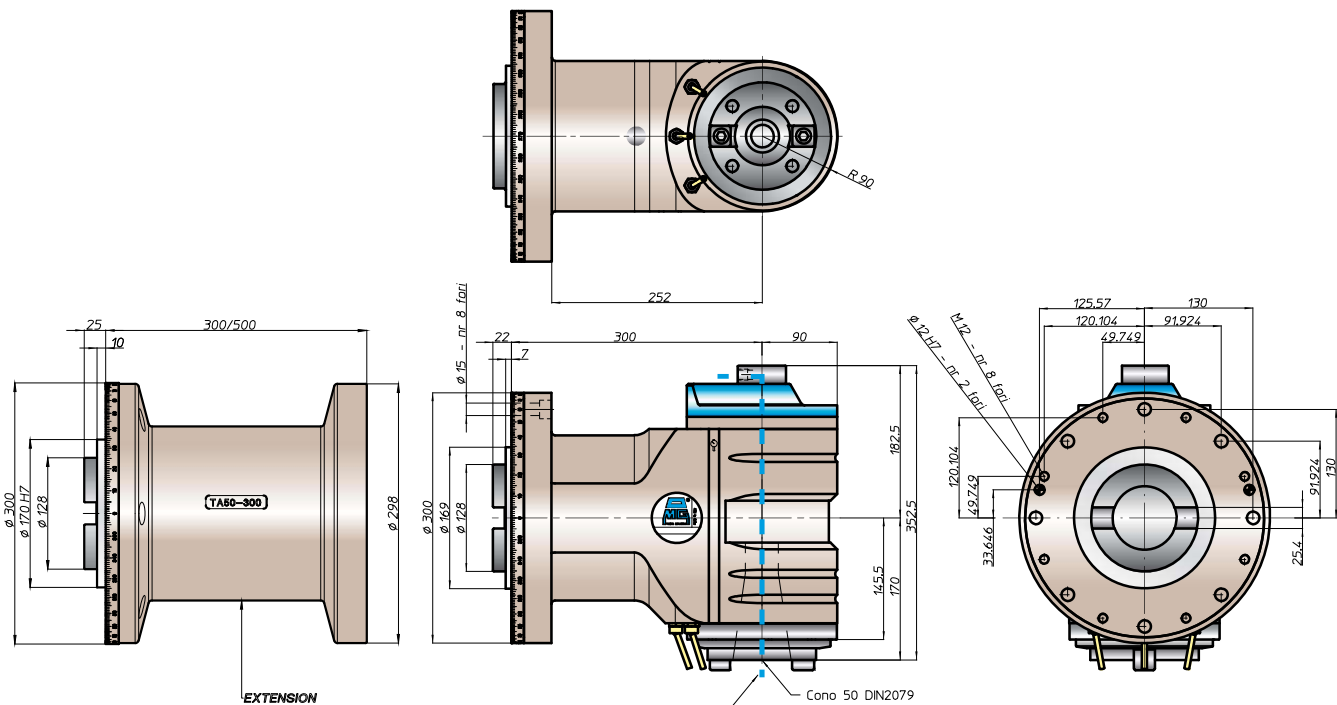

Equipaggiamento standard:

- pressurizzazione mandrino
- n. 3 ugelli orientabili vicino al mandrino
- nel mandrino DIN2079 si possono utilizzare coni DIN69871-A50, MAS403-BT50

Standard equipment:

- spindle front pressurization
- nr 3 adjustable nozzle near the spindle
- on the spindle DIN2079 you can use shank DIN69871-A50, MAS403-BT50

esempio di collegamento rotante - rotating connection example

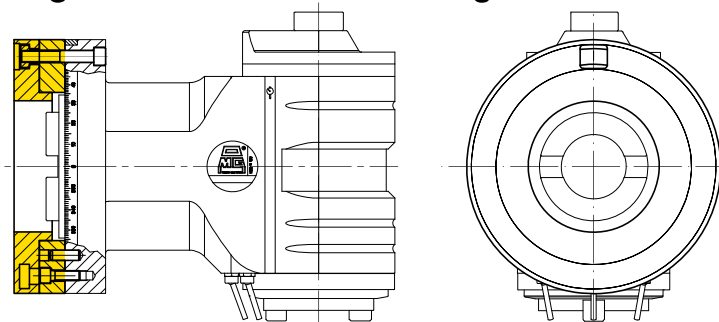

FH

BAH

TA-CP

TA

MOX

HT

VH

TSI/TSX

T

MT-TC-TC3

Accessori
Accessories

Appendice tecnica
Technical supplement



TA..T Extended Gallery



TA..T Extended Gallery



FH

BAH

TA..CP

TA

MOx

HT

VH

TSI/TSX

T

MT-TC-TC3

Accessori
Accessories

Appendice tecnica
Technical supplement

